



FEATURES:

- High quality bronze body
- Horizontal swing pattern

MATERIAL SPECIFICATION

Description	Material
Body	Bronze CC491K
Cap	Bronze CC491K
Disc	Bronze CC491K
Hinge	Brass CW617N
Hinge Pin	Stainless Steel Type 420
Hinge Nut	Brass CW617N

PRESSURE / TEMPERATURE RATING

20 Bar from -10°C to 100°C

HYDROSTATIC TEST PRESSURE

Shell: 30 bar

Seat: 22 bar

SPECIFICATION

Designed to BS 5154

Horizontal swing pattern

Threaded cover

Metal to metal seat

Suitable for mounting in horizontal and vertical pipe (with vertical flow upwards)

Taper threaded to BS EN 10226-2 (ISO-7) formerly BS 21

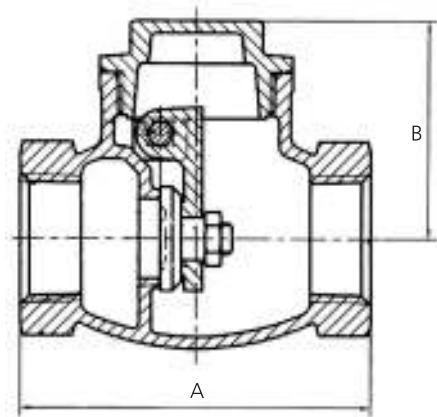

DIMENSIONS & WEIGHT

DN	Inches	A (mm)	B (mm)	Weight (kg)
15	½	58	37	0.25
20	¾	66	43	0.40
25	1	76	49	0.61
32	1¼	88	57.5	0.87
40	1½	96	63	1.16
50	2	112	72	1.80

All dimensions are nominal (indicative). Actual dimensions may vary.

